

Campus Food Service POS Updates for Fall 2025

Last Modified on 10/09/2025 3:03 pm CDT

Before Updating to Campus.2539 and Beyond

All Campus Food Service districts using POS terminals must confirm the terminal application version is higher than 2.23.4. This update is critical for your POS terminals to function and for transactions to process.

- A notification had been posted with a prior Rx release ([Campus Food Service: Important POS Terminal Information](#)), prompting users to update their terminal version to 2.23.5 or higher. POS terminal versions can be confirmed on the terminal login page.

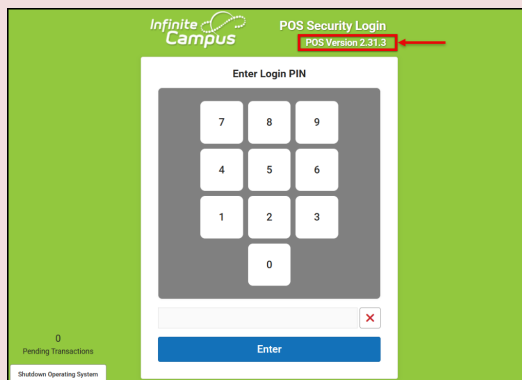

- When a terminal version needs to be manually updated, users can update it by logging into their Campus site on the terminal, navigating to Food Service > Administration > Terminals, and clicking Install.

Updating to POS 3.1.0 in Campus.2543

The Campus.2543 update will include the following changes that will assist with keeping the Campus SIS and the POS Terminal in sync to ensure successful transaction processing. We strongly recommend that the POS Terminal Version should also be updated at that time:

Major Update Feature

When Infinite Campus releases a major update that requires database changes for the POS Terminal application, it now requires the application to be updated before it can be used.

- When a major update occurs, a pop-up will display when the application is opened, indicating an update is being taken immediately.

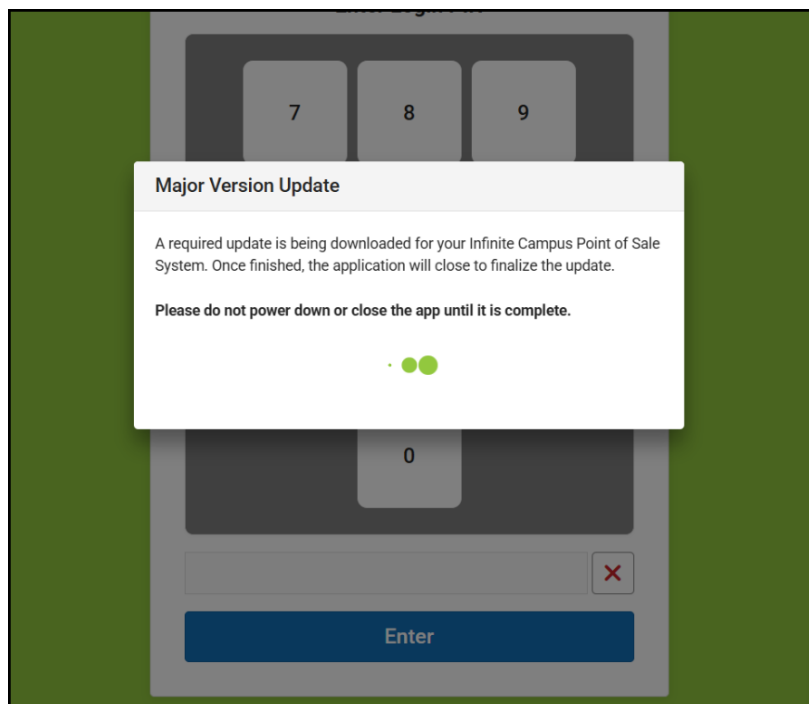

POS Display Health Comments

A new POS Display Health Comments field, displaying text on the Point of Sale Terminal, was added to the student Conditions tool for Food Service users. Entered text displays on Food Service Terminals for the student, such as nut or fish allergies.

- Each POS Terminal must be updated to POS Version 3.1.0 before any entered comments will display.

Enhance POS Display Flags

Student Flag Start Date and End Date have been added to the POS terminal to determine if the status of the flag warning is valid without completing a data reload on the terminal.

- All previously entered flags will continue to be displayed on POS Terminals, but each POS Terminal must be updated to POS Version 3.1.0 before any flags entered after updating to Campus.2543 will display.

Auto-close Terminal Application Daily at 2:00 am

Allows all terminals to take required updates when needed.

Forced Reload Function

POS Application updates sometimes require a data reload to accommodate newly released functionality (such as the new POS Display Health Comments and expanded POS Flag functionality). The POS Application will now automatically perform a data reload when needed.

- A pop-up will display when the application is opened, indicating a reload is occurring.

Time-out Feature

The default value is 5 minutes, allowing for configurations between 3 and 90 minutes. Ensures that terminals are not left open and unattended.
