

P-EBT Extract (Nebraska) [.2251 - .2323]

Last Modified on 06/15/2023 10:42 am CDT

You are viewing a previous version of this article. See [P-EBT Extract \(Nebraska\)](#) for the most current information.

[Report Logic](#) | [Report Editor](#) | [Generate the P-EBT Extract](#) | [Report Layout](#)

Classic View: NE State Reporting > P-EBT Extract

Search Terms: P-EBT Extract

The P-EBT (Pandemic Electronic Benefits) Extract returns data on students who are eligible for free/reduced-price meals and meet the criteria to receive P-EBT in the calendar selected in the Campus toolbar.

Nebraska P-EBT Extract

Report Logic

Only those students who qualify for free or reduced-price meals and who attended school due to the following are included:

- The school was primarily operating in a Remote Only or Hybrid learning mode due to COVID-19.
- The student opted into attending remotely full time.
- The student was forced to attend remotely for a short time due to quarantine.

One record per student who has an enrollment in the selected calendar(s) at any time during the reporting period (entered Start and End Dates on the Report Editor) are included. When a student has more than one enrollment, the most recent enrollment reports.

Students who are included in the report must meet **both** of the following requirements:

- They qualify for Free/Reduced meals by the submission of an income application or direct certification during the school year; AND
- They experience a COVID-related absence for any period.

COVID-related absences that are greater than five days are included in the aggregate count of absences. Absences that total less than five days are included as long as there are other students who were absent for five or more days. When there are no students who were absent for five or more days due to COVID, no data is returned.

Students are not included when:

- The enrollment record is marked as No Show or as State Exclude.
- The grade level of enrollment is marked as State Exclude.
- The calendar of enrollment is marked as State Exclude.

When a calendar is NOT marked as Summer School, students do not report UNLESS a student would report as being absent for five or more days. A summer school calendar is determined by the checkbox on the [Calendar Information](#) tool.

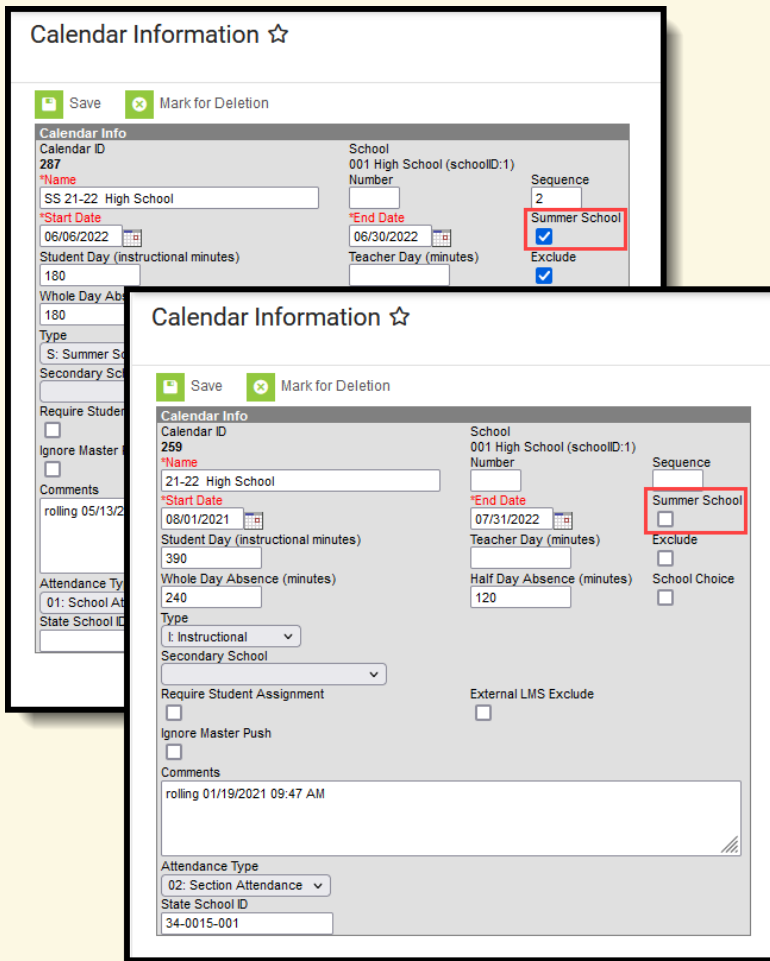

Report Editor

Field	Description
Start Date	Entered date is used to return student data for those students actively enrolled on or after the entered date. Dates are entered <i>mmdyy</i> format or can be entered by selecting the calendar icon and choosing a date.
End Date	Entered date is used to return student data for those students actively enrolled on or before the entered date. Dates are entered <i>mmdyy</i> format or can be entered by selecting the calendar icon and choosing a date.
Ad hoc Filter	Select a saved ad hoc filter to only include those students in the filter in the report, assuming those students meet the reporting logic and business rules of this report.
Attendance Code Selector	Selection is used to calculate the total number of instructional days students are absent from school or are doing virtual learning due to COVID. It is assumed that all attendance events assigned the selected code are due to COVID-related absences.
Format	The P-EBT Extract can be generated in either CSV or HTML formats.
Report Generation	The P-EBT Extract can be generated immediately using the Generate Report button. Or, use the Submit to Batch button to select when the report is generated. See the Batch Queue article for more information on this functionality.

Generate the P-EBT Extract

1. Enter the appropriate **Start Date** and **End Date** for the extract.
2. If desired, select students from an existing **Ad hoc Filter**.
3. Select the appropriate COVID-related Attendance Code from the **Attendance Code Selector** list.
4. Select the **Format** of the report.
5. Click the **Generate Extract** button or use the **Submit to Batch** button. The report displays in the desired format.

P-EBT Extract Records: Records:179															
Parent/Guardian First Name	Parent/Guardian Last Name	Primary Language Spoken	Address Line 1	Address Line 2	City	State	Zip Code	Parent Phone Number	Parent Email Address	Student First Name	Student Last Name	Student Birth Date	NDE Student ID	NDE School Agency ID	Days Absent or Remote from COVID
Amber	Parent	1290	571 Florida Ave		Beatrice	NE	68310	4025550168		Fiona	Student	2003-10-31	123456789	34-0015-001	4.172
Belinda	Parent	1290	8121 S 81st St		Beatrice	NE	68310	4025550102		George	Student	2005-06-28	234567890	34-0015-001	3.044
Carol	Parent	1290	4271 S 51st Ave		Beatrice	NE	68310	4025550193		Henry	Student	2006-09-15	345678901	34-0015-001	0.783
Diane	Parent	1290	4121 Truman Road		Beatrice	NE	68310	4025550091		Isaac	Student	2005-02-25	456789012	34-0015-001	1.888
Emily	Parent	1290	2281 Ann Parkway		Beatrice	NE	68310	4025550188		Janna	Student	2004-03-08	567890123	34-0015-001	5.865

P-EBT Extract - HTML Format

1	A	B	C	D	E	F	G	H	I	J	K	L	M	N	O	P	Q	R	S
2	Parent/Gu	Parent/Gu	Primary La	Address LI	Address LI	City	State	Zip Code	Parent Phone Number	Parent Em	Student FI	Student La	Student Birth Date	NDE Student ID	NDE Schoc	Days Absent or Remote from COVID			
2	Amber	Parent	1290	571 Florida Ave		Beatrice	NE	68310	402550168		Fion	Student	10/31/2003	12345678	34-0015-00	4.172			
3	Belinda	Parent	1290	8121 S 81st St		Beatrice	NE	68310	402550102		George	Student	6/28/2005	23456789	34-0015-00	3.044			
4	Carol	Parent	1290	5382 S 51st Ave		Beatrice	NE	68310	402550193		Henry	Student	9/15/2006	34567890	34-0015-00	0.783			
5	Diane	Parent	1290	4121 Truman Road		Beatrice	NE	68310	402550091		Isaac	Student	2/25/2005	45678901	34-0015-00	1.888			
6	Emily	Parent	1290	2281 Ann Parkway		Beatrice	NE	68310	402550188		Janna	Student	3/8/2004	56789012	34-0015-00	5.865			

P-EBT Extract - CSV Format

Report Layout

Data Element	Description	Location
Parent/Guardian First Name	<p>Reports the first name of the person marked as Primary Guardian.</p> <p>Parent/Guardian information reports as follows:</p> <ul style="list-style-type: none"> The Primary and current Household is determined first. The current address reports from the primary and current household. The individual marked as Guardian in that primary and current household who has the lowest personID reports as the Guardian on the report. <p><i>Alphanumeric, 30 characters</i></p>	<p>Census > People > Relationships > Primary Household Relationships > Guardian</p> <hr/> <p>Census > People > Demographics > Person Information > First Name</p> <p>Identity.firstName</p>

Data Element	Description	Location
<p>Parent/Guardian Last Name</p>	<p>Reports the last name of the person marked as Primary Guardian.</p> <p>Parent/Guardian information reports as follows:</p> <ul style="list-style-type: none"> • The Primary and current Household is determined first. • The current address reports from the primary and current household. • The individual marked as Guardian in that primary and current household who has the lowest personID reports as the Guardian on the report. <p><i>Alphanumeric, 30 characters</i></p>	<p>Census > People > Relationships > Primary Household Relationships > Guardian</p> <hr/> <p>Census > People > Demographics > Person Information > Last Name</p> <p>Identity.lastName</p>
<p>Primary Language Spoken</p>	<p>Reports the assigned Primary Language code.</p> <p>When the Home Primary Language field is not populated, the default value on the attribute reports.</p> <p><i>Alphanumeric, 3 characters</i></p>	<p>Census > People > Identities > Home Primary Language</p> <p>Identity.homePrimaryLanguage</p>

Data Element	Description	Location
<p>Address Line 1</p>	<p>Reports the student's mailing address (street address when entered, or PO Box when marked).</p> <p>The student's current and primary address reports.</p> <p>When there is no address available for the student, the school's address reports.</p> <p><i>Alphanumeric, 44 characters</i></p>	<p>Census > Households > Addresses > Address</p> <p>Address.number Address.POBox Address.street Address.prefix Address.tag Address.direction Address.apt</p> <hr/> <p>System Administration > Resources > School > School Detail > Address</p> <p>School.address</p>
<p>Address Line 2</p>	<p>N/A</p>	<p>N/A</p>
<p>City</p>	<p>Reports the student's city as noted on their primary address. When there is no city available for the student, the school's city reports.</p> <p><i>Alphanumeric, 50 characters</i></p>	<p>Census > Households > Addresses > Address</p> <p>Address.city</p> <hr/> <p>System Administration > Resources > School > School Detail > Address</p> <p>School.city</p>
<p>State</p>	<p>Reports the student's state as noted on their primary address. When there is no state available for the student, the school's state reports.</p> <p><i>Alphanumeric, 2 characters</i></p>	<p>Census > Households > Addresses > Address</p> <p>Address.state</p> <hr/> <p>System Administration > Resources > School > School Detail > Address</p> <p>School.state</p>

Data Element	Description	Location
Zip Code	<p>Reports the zip code (either 5 digit code or 9 digit code) of the parent's primary household address. When there is no zip code available for the student, the school's zip code reports.</p> <p><i>Numeric, 10 digits (12345 or 12345-6789)</i></p>	<p>Census > Households > Addresses > Address</p> <p>Address.zip</p> <hr/> <p>System Administration > Resources > School > School Detail > Address</p> <p>School.zip</p>
Parent Phone Number	<p>Reports the 10-digit primary phone number assigned at the household, including area code (no dashes).</p> <p>When there is no phone number for the household, this field reports blank.</p> <p><i>Numeric, 10 digits</i></p>	<p>Census > People > Households > Address > Phone Number</p> <p>Household.phone</p>
Parent Email Address	<p>Reports the email address of the primary parent/guardian.</p> <p>When there is no email address for the household, this field reports blank.</p> <p><i>Alphanumeric, 50 characters</i></p>	<p>Census > People > Demographics > Personal Contact Information > Email</p>
Student First Name	<p>Reports the student's first name.</p> <p>When the Report Legal Name checkbox is marked, the student's First Name reports from the Legal First Name field.</p> <p><i>Alphanumeric, 30 characters</i></p>	<p>Census > People > Demographics > Person Information > First Name</p> <p>Identity.firstName</p> <hr/> <p>Census > People > Identities > Protected Identity Information > Legal First Name</p> <p>Identity.legalFirstName</p>

Data Element	Description	Location
<p>Student Last Name</p>	<p>Reports the student's last name.</p> <p>When the Report Legal Name checkbox is marked, the student's Last Name reports from the Legal Last Name field.</p> <p><i>Alphanumeric, 30 characters</i></p>	<p>Census > People > Demographics > Person Information > Last Name</p> <p>Identity.lastName</p> <hr/> <p>Census > People > Identities > Protected Identity Information > Legal Last Name</p> <p>Identity.legalLastName</p>
<p>NDE Student ID</p>	<p>Reports the unique number assigned to a student by the Department of Education.</p> <p><i>Numeric, 10 digits</i></p>	<p>Census > People > Demographics > Person Identifiers > Student State ID</p> <p>Person.stateID</p>
<p>NDE School Agency ID</p>	<p>Reports the 11-digit identification number assigned to the school of enrollment. This is used to match the student to the learning mode of their school during the given month.</p> <p>Reports the State District Number + School State ID</p> <p><i>Numeric, 11 digits (XX-XXXX-XXX)</i></p>	<p>System Administration > Resources > District Information > State District Number</p> <p>District.stateNumber</p> <hr/> <p>System Administration > Resources > School > State School Number</p> <p>School.stateSchoolNumber</p>

Data Element	Description	Location
<p>Days Absent or Remote from COVID</p>	<p>Reports the total number of instructional days the reported student was not in the classroom (absent or remote learning) due to COVID during the month.</p> <p>Reports the aggregated total days of learning for the student for the given Start Date and End Date.</p> <p>Districts may sum any partial days amounts.</p> <p>This is calculated based on the Attendance Code selected on the Report Editor.</p> <p>When there are no absent or remote days for the student, a value of 0 (zero) reports.</p> <p><i>Numeric, 5 digits (XX.XXX)</i></p>	<p>Calculated value</p> <p>Student Information > General > Attendance</p> <p>Attendance.status Attendance.excuse</p>

Previous Versions

[P-EBT Extract \(Nebraska\) \[.2219 - .2247\]](#)