

History/Government Assessment Setup (Kansas)

Last Modified on 10/21/2024 8:20 am CDT

[Step 1. Create New Parent Test](#) | [Step 2. Create New Child Tests](#) | [Step 3. Align Assessments to Courses](#) | [Step 4. Teachers Score Assessments](#) | [Step 5. Review Scores for Students](#)

Tool Search: Test Setup

In order to accurately collect data used in the [KIDS EOYA Extract](#), certain tests need to be added following the process below.

Step 1. Create New Parent Test

1. In the Test Setup tool, click **New Test**.
2. Enter the **History/Gov Assessment** in the **Name** field.
3. Choose the **Subject** of **Hist/Gov** from the dropdown list.
4. Select **District Test** for the **Test Type**.
5. Click **Save** when finished.

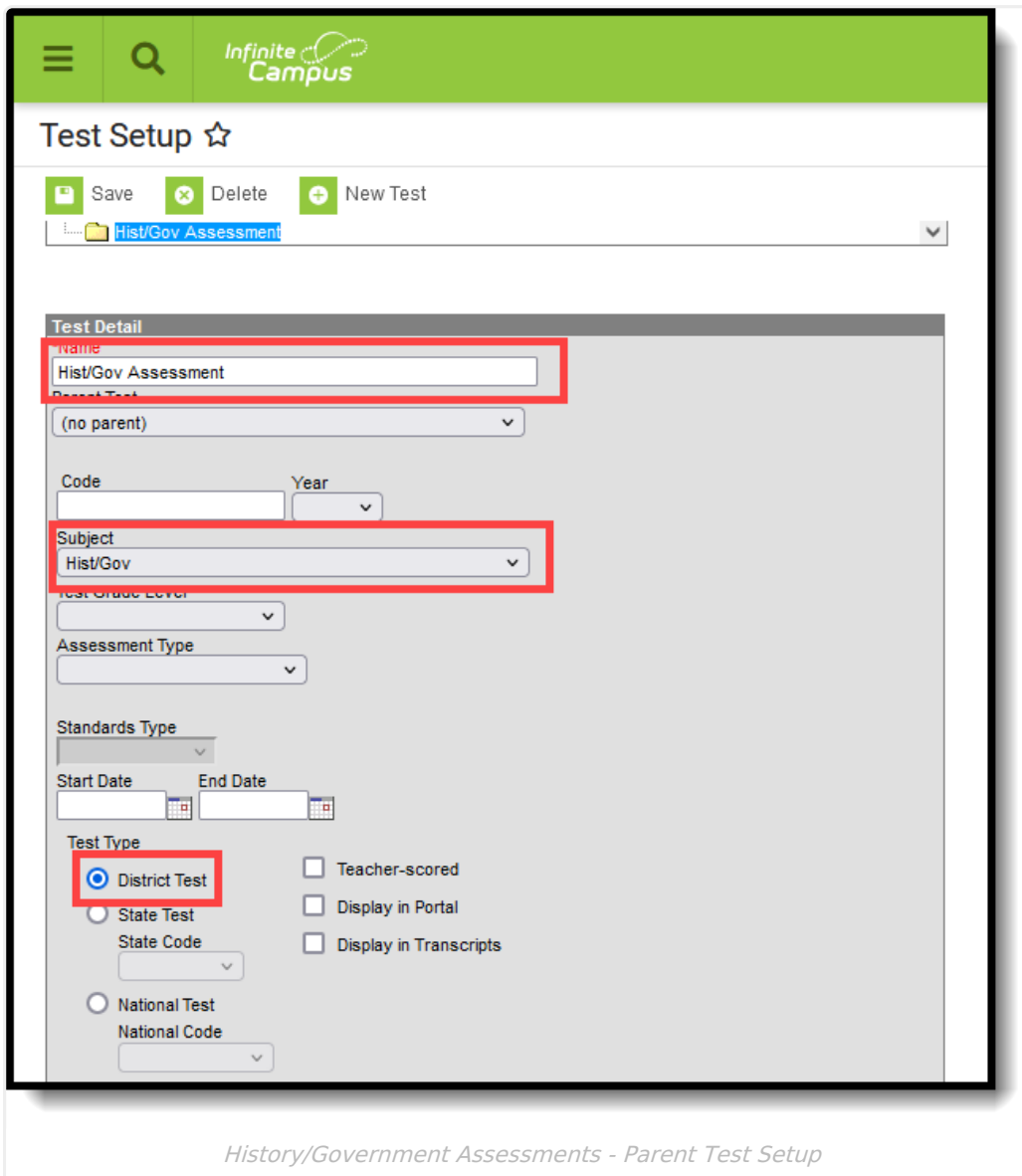

Step 2. Create New Child Tests

Classic View: Student Information > Assessment Administration > Test Setup

Repeat this step THREE times. In the end, there will be three child test for the History/Government Assessment. Each child test uses the same Result Statuses. See the images for an example.

- The value for each code is a Raw Score that equates to a given performance level. For example, if a score of 1-49 is a performance level of 1, enter 1 as the value for Result Code'01 and a 50 as the value for Result Code 02.
- The Label for each code identifies which performance level for the result.

Note that the name of the test does not matter as reports look at the Code assigned to the test. As long as each test is easily identified as the appropriate score.

Code 01: Claim/Thesis

1. In the Test Setup tool, click **New Test**.
2. Enter a **Name** for the test that identifies is as the **Claim/Thesis** test - like Claim/Thesis or 01: Claim/Thesis, or 01.
3. In the **Parent Test** field, choose **History/Gov Assessment**.
4. Enter **01** in the Code field.
5. Choose the **Subject** of **Hist/Gov** from the dropdown list.
6. In the Test Type section, select or mark the following:
 - **District Test** for the **Test Type**.
 - **Teacher-scored** checkbox
7. In the **Select the score fields you want to use** section, mark **Result** and **Raw**.
8. Add **Result Statuses** using 01-06 for the Result Code. Refer to the image for an example.
9. Click **Save** when finished.

Test Detail

01: Claim/Thesis
 Parent Test
 -Hist/Gov Assessment

Code: 01 Year: [v]
 Subject: Hist/Gov

Test Grade Level: [v]
 Assessment Type: [v]
 Standards Type: [v]
 Start Date: [v] End Date: [v]

Test Type:
 District Test
 State Test
 National Test

Teacher-scored
 Display in Portal
 Display in Transcripts

Select the score fields you want to use:
 Date Scale Score Raw Score Reason Code
 Received Accommodation Percentile Percent Normal Curve Equivalent
 Result Invalid Test Accommodations Eligible

Academic Achievement Standard: [v]

Question Label: [v]

Result Statuses				
	Value	Result Code	Label	Passing Score
X	150	04	Performance Level 4	<input type="checkbox"/>
X	100	03	Performance Level 3	<input type="checkbox"/>
X	50	02	Performance Level 2	<input type="checkbox"/>
X	1	01	Performance Level 1	<input type="checkbox"/>
X	200	05	Student refused to test	<input type="checkbox"/>
X	250	06	Student exempt from testing	<input type="checkbox"/>

Add Result Status

History/Government Assessment - Code 01: Claim/Thesis

Code 02: Evidence

1. In the Test Setup tool, click **New Test**.
2. Enter a **Name** for the test that identifies is as the **Evidence** test - like Evidence or 02: Evidence, or 02.
3. In the **Parent Test** field, choose **History/Gov Assessment**.

4. Enter **02** in the Code field.
5. Choose the **Subject** of **Hist/Gov** from the dropdown list.
6. In the Test Type section, select or mark the following:
 - **District Test** for the **Test Type**.
 - **Teacher-scored** checkbox
7. In the **Select the score fields you want to use** section, mark **Result** and **Raw**.
8. Add **Result Statuses** using 01-06 for the Result Code. Refer to the image for an example.
9. Click **Save** when finished.

Test Detail

***Name**
02: Evidence

Parent Test
-:Hist/Gov Assessment

Code
02 **Year**

Subject
Hist/Gov

Test Grade Level

Assessment Type

Standards Type

Start Date **End Date**

Test Type

District Test **Teacher-scored**

State Test **Display in Portal**

National Test **Display in Transcripts**

Select the score fields you want to use:

Date **Scale Score** **Raw Score** **Reason Code**

Received Accommodation **Percentile** **Percent** **Normal Curve Equivalent**

Result **Invalid** **Test Accommodations Eligible**

Academic Achievement Standard

Question Label

Result Statuses				
	Value	Result Code	Label	Passing Score
X	150	04	Performance Level 4	<input type="checkbox"/>
X	100	03	Performance Level 3	<input type="checkbox"/>
X	50	02	Performance Level 2	<input type="checkbox"/>
X	1	01	Performance Level 1	<input type="checkbox"/>
X	200	05	Student refused to test	<input type="checkbox"/>
X	250	06	Student exempt from testing	<input type="checkbox"/>

Add Result Status

History/Government Assessment - Code 02: Evidence

Code 03: Reasoning

1. In the Test Setup tool, click **New Test**.
2. Enter a **Name** for the test that identifies is as the Reasoning - like Reasoning or 03: Reasoning, or 03.
3. In the **Parent Test** field, choose **History/Gov Assessment**.

4. Enter **03** in the Code field.
5. Choose the **Subject** of **Hist/Gov** from the dropdown list.
6. In the Test Type section, select or mark the following:
 - **District Test** for the **Test Type**.
 - **Teacher-scored** checkbox
7. In the **Select the score fields you want to use** section, mark **Result** and **Raw**.
8. Add **Result Statuses** using 01-06 for the Result Code. Refer to the image for an example.
9. Click **Save** when finished.

Test Detail

***Name**
03: Reasoning

Parent Test
-:Hist/Gov Assessment

Code: 03 Year: [v]

Subject
Hist/Gov

Test Grade Level
[v]

Assessment Type
[v]

Standards Type
[v]

Start Date: [calendar] End Date: [calendar]

Test Type

District Test Teacher-scored

State Test Display in Portal

State Code: [v] Display in Transcripts

National Test National Code: [v]

Select the score fields you want to use:

Date Scale Score Raw Score Reason Code

Received Accommodation Percentile Percent Normal Curve Equivalent

Result Invalid Test Accommodations Eligible

Academic Achievement Standard
[v]

Question Label
[text box]

Result Statuses				
	Value	Result Code	Label	Passing Score
X	150	04	Performance Level 4	<input type="checkbox"/>
X	100	03	Performance Level 3	<input type="checkbox"/>
X	50	02	Performance Level 2	<input type="checkbox"/>
X	1	01	Performance Level 1	<input type="checkbox"/>
X	200	05	Student refused to test	<input type="checkbox"/>
X	250	06	Student exempt from testing	<input type="checkbox"/>

Add Result Status

History/Government Assessment - Code 03: Reasoning

When finished creating the child tests, the History/Government Parent Test folder should look similar to this:

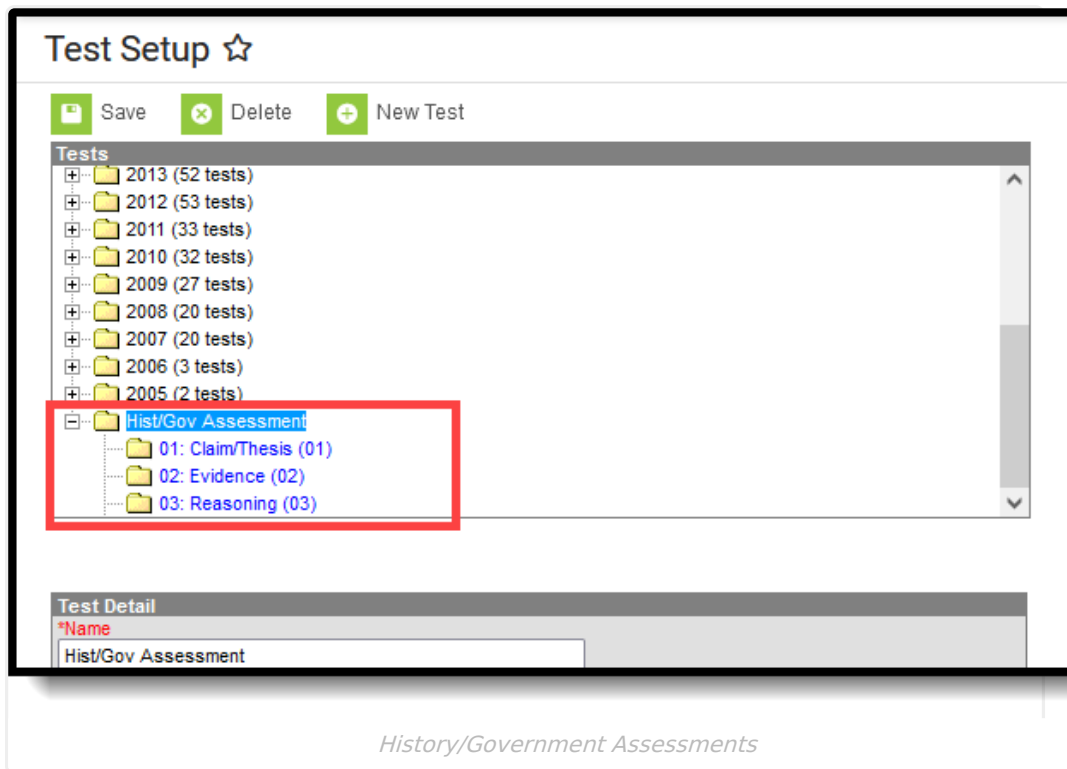

Step 3. Align Assessments to Courses

Classic View: Scheduling & Courses > Courses > Course Assessments

1. Click the **New** icon to add the new History/Government assessments to the appropriate courses.
2. In the **Test** field, enter Hist/Gov to narrow the available tests. The child tests created in Step 2 display.
3. Select one of the child tests to align to the course.
4. Enter a **Start Date** and **End Date**. These dates could be the Term Dates for when the course meets or the dates of when the assessment is administered.
5. Click **Save** when finished.
6. Repeat this alignment process three times - one for each child test - for each course where history/government information is taught.

Course Assessments ☆
002002 WORLD HISTORY

Save New

Assessment Alignment Editor

Teacher-scored tests Read-only tests

Standard	Assessment Name	Start Date	End Date	Copies Forward

Assessment Alignment Detail

Teacher-scored tests are indicated with an asterisk(*)

*Test

- *03: Reasoning
- February 2020 ACT Reading (2020)
- February 2020 ACT Science-State testing (2020)
- February 2020 ACT Science (2020)
- February 2021 ACT Composite (2021)
- February 2021 ACT English (2021)
- February 2021 ACT Math (2021)
- February 2021 ACT Reading (2021)
- February 2021 ACT Science (2021)
- Hist/Gov Assessment
- *01: Claim/Thesis
- *02: Evidence
- *03: Reasoning
- January 2017 SAT ERPW (2017)
- January 2017 SAT Math (2017)
- January 2017 SAT Total (2017)
- January 2021 PSAT ERPW (2021)

Course Assessment Alignment of Child Tests

The Course Assessment list should look similar to this when finished:

Course Assessments ☆
002002 WORLD HISTORY

New

Assessment Alignment Editor

Teacher-scored tests Read-only tests

Standard	Assessment Name	Start Date	End Date	Copies Forward
	01: Claim/Thesis	09/01/2021	11/15/2021	
	02: Evidence	11/20/2021	01/15/2022	
	03: Reasoning	01/20/2022	04/01/2022	

Course Assessment Alignment for History/Government

Step 4. Teachers Score Assessments

Classic View: Instruction > Classroom Administration > Standardized Test

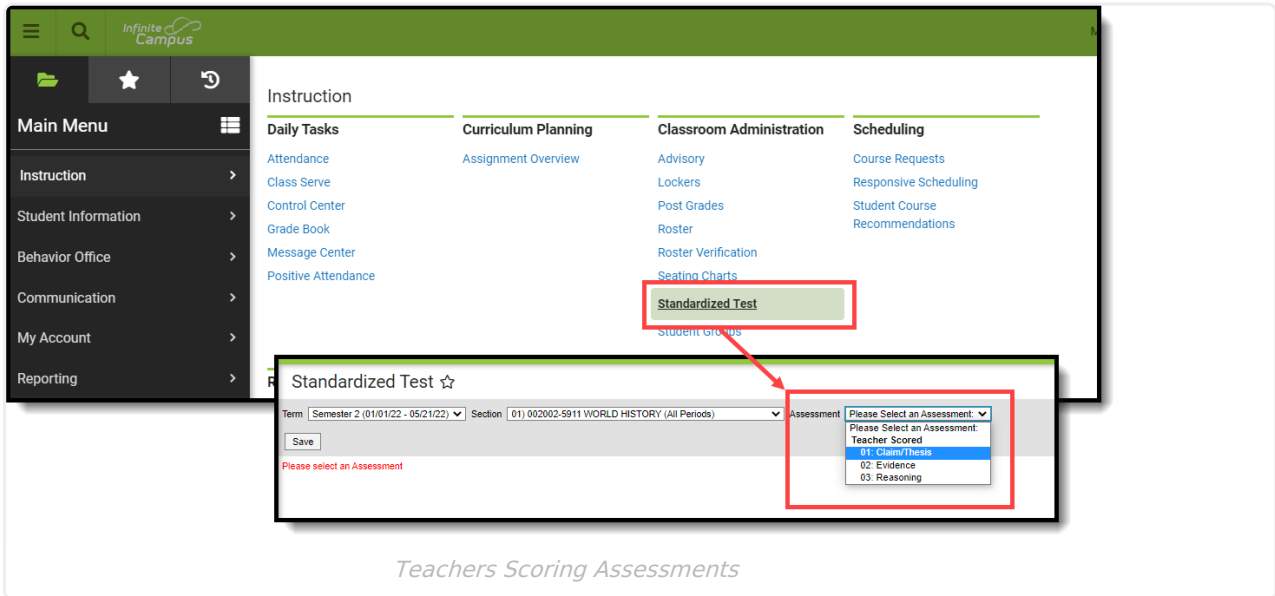

1. Review the Term and Section selected in the Campus toolbar for the correct selection.
2. Select the appropriate **Assessment** to score from the Assessment field in the Campus toolbar. Look for the assessments marked as **Teacher Scored**.
3. Enter the **Scores** for the students. The **Result** populates automatically upon saving.
4. Click the **Save** button when finished.



Administrative staff can also score these assessments from the [Section Grading by Student](#) or [Section Grading by Task](#) tools.

Step 5. Review Scores for Students

Assessment scores can be viewed on the student's [Assessment](#) tool. Scores can be modified here if necessary.

  Infinite Campus

 **Assessment** ☆
Student, Micah Grade: 09 #12345 DOB: 04/21/06

Save **New** **Delete** **Print** **Documents**

Test Scores

- FB aReading Winter 19-20 Scale Score:565.18 Result:CP
- FB aReading Winter 20-21 Scale Score:551.8 Result:LowRisk
- Hist/Gov Assessment**
 - 01: Claim/Thesis (01) 03/01/2022 Raw Score:150 Result:**
 - 02: Evidence (02) 03/01/2022 Raw Score:95 Result:04
 - 03: Reasoning (03) 03/01/2022 Raw Score:75 Result:03
- Spring 2014 MAP Primary Math Scale Score:187 Result:
- Spring 2014 MAP Primary Reading Scale Score:185 Result:
- Spring 2015 MAP Primary Math Scale Score:207 Result:
- Spring 2015 MAP Primary Reading Scale Score:196 Result:
- Spring 2016 MAP Math Scale Score:214 Result:78
- Spring 2016 MAP Reading Scale Score:217 Result:89
- Spring 2017 MAP Math Scale Score:218 Result:

Test Score Detail

01: Claim/Thesis

Raw Score

Proficiency Level

Student Assessment Scores