

Connecting POS Terminals: Terminal Cables, Ports and Connectors

Last Modified on 07/15/2024 1:49 pm CDT

POS Terminal Cables, Ports and Connectors

This section provides detailed instructions for properly connecting POS terminals:

Disabled Ports

The following ports are disabled. Do not connect any cables to them:

ELO 15B1

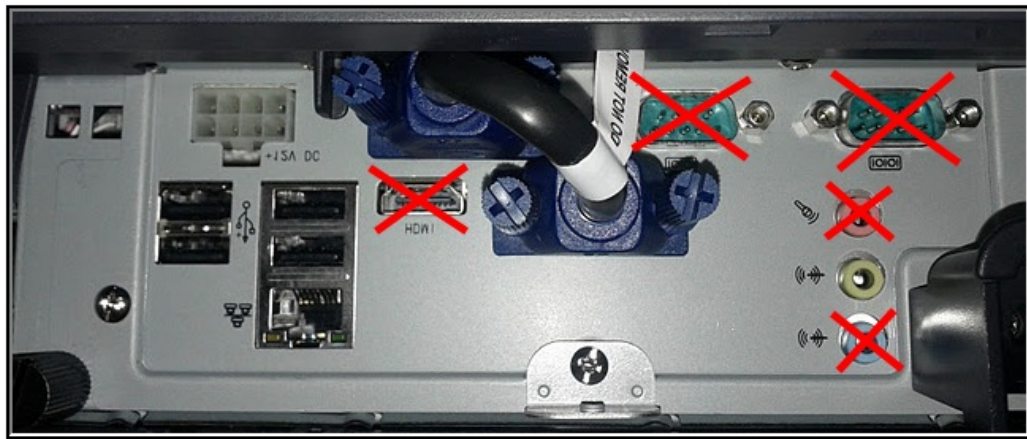

POSX TP4A-C/POSX TP4C-C



I. Access the Ports

To access the ports:

Terminal Model	To Access the Ports
ELO 15B1	Tilt the screen all the way up. The ports will be directly underneath the screen.

II. Cables

1. Plug in the power cable. Connect the port end of the power cable to the POS power supply input.

Do not plug in the electrical source to an outlet until instructed

ELO Power Supply Input



2. Plug the network data cable into the RJ-45 port labeled "Ethernet". This port may also be labeled with the standard ethernet logo (see below).

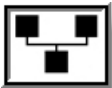

III. Hardware: PIN Pad, Barcode Scanner, Keyboard, Mouse, Cash Drawer, Wireless Module

Connect POS hardware as follows:

1. Plug the PIN pad and/or barcode scanner into any USB port.
2. If desired, plug in an PC-compatible mouse and/or keyboard:
 - **ELO 15B1:** Plug the mouse and keyboard into a USB port or PS/2 port labeled for each item.
3. If a cash drawer will be used:
 - **ELO Terminals:** Plug one end of the USB cable into the rear of the cash drawer and the other end into a USB port on the terminal. Plug the 12V AC adapter into the rear of the cash drawer and the other end into a 120V outlet.
4. The wireless module is meant to be plugged into one of the two USB ports located underneath the LCD monitor.

IV. Finish

1. Route all cables under the cord retainer and secure it with a thumb screw.
2. Replace the rear modesty cover in the reverse of how it was removed.